

# CHR 150-6

6V 150AH

High Rated



## CHR150-6

Awaiting Image

## Physical Specification

Part Number:	<b>CHR150-6</b>
Length:	<b>260 ± 2 mm (10.2 inches)</b>
Width:	<b>180 ± 2 mm (7.09 inches)</b>
Container Height:	<b>247 ± 2 mm (9.72 inches)</b>
Total Height (with terminal):	<b>253 ± 2 mm (9.96 inches)</b>
Approx Weight:	<b>Approx 21.2 Kg (46.7lbs)</b>

## Specifications

	Nominal Voltage	6V
	Nominal Capacity (20HR)	150AH
Terminal Type	Standard Terminal	T7
	Optional Terminal	-
Container Material	Standard Option	ABS
	Flame Retardant Option (FR)	ABS (UL94:VO)
Rated Capacity	155.0 AH/15.5A	(20hr, 1.80V/cell, 25°C / 77°F)
	150.0 AH/18.75A	(10hr, 1.80V/cell, 25°C / 77°F)
	131.0 AH/26.2A	(5hr, 1.75V/cell, 25°C / 77°F)
	117.3 AH/39.1A	(3hr, 1.75V/cell, 25°C / 77°F)
	101.3 AH/101.3A	(1hr, 1.60V/cell, 25°C / 77°F)
Max Discharge Current	1500A (5s)	
Internal Resistance	Approx 3mΩ	
Discharge Characteristics	Operating Temp. Range	Discharge: -15 ~ 50°C (5 ~ 122°F)
		Charge: 0 ~ 40°C (5 ~ 104°F)
		Storage: -15 ~ 40°C (5 ~ 104°F)
	Nominal Operating Temp. Range	25 ± 3°C (77 ± 5°F)
	Cycle Use	Initial Charging Current less than 45.0A. Voltage 7.2V ~ 7.5V at 25°C (77°F) Temp. Coefficient -15mV/°C
	Standby Use	No limit on Initial Charging Current Voltage 6.75V ~ 6.9V at 25°C (77°F) Temp. Coefficient -10mV/°C
Capacity affected by Temperature	40°C (104°F)	103%
	25°C (77°F)	100%
	0°C (32°F)	86%
Design Floating Life at 20°C	12 + Years	
Self Discharge	Canbat batteries may be stored for up to 6 months at 25°C(77°F) and then a refresh charge is required. For higher temperatures the time interval will be shorter.	

## Dimensions

### T7 Terminal

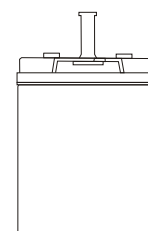
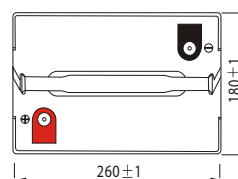
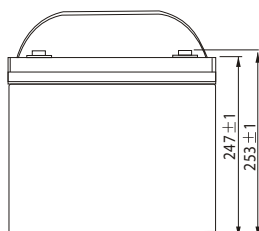
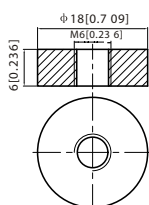

ALL DATA IS SUBJECT TO CHANGE WITHOUT NOTICE

## Constant Power Discharge (Watts/Cell) at 25 °C (77°F)

F.V/Time	5min	10min	15min	20min	30min	45min	1h	2h	3h	4h	5h	6h	8h	10h	20h
1.85V/cell	185.8	149.7	137.5	120.5	97.7	76.0	62.1	35.1	25.6	20.3	17.3	14.7	12.0	10.0	5.33
1.80V/cell	244.5	185.7	161.3	138.2	111.9	85.7	67.5	37.6	26.7	21.0	17.4	15.1	12.5	10.4	5.42
1.75V/cell	275.7	204.0	176.2	148.7	116.2	89.0	70.6	39.0	27.2	21.4	17.8	15.6	12.7	10.5	5.47
1.70V/cell	303.6	222.3	188.2	156.4	119.9	91.7	72.8	40.4	27.9	22.0	18.2	15.9	12.9	10.6	5.57
1.67V/cell	334.8	240.0	200.1	166.1	125.7	94.6	75.5	41.6	29.2	22.8	18.7	16.3	13.2	10.8	5.64
1.60V/cell	369.4	260.5	214.1	176.9	131.2	98.9	78.0	43.1	30.1	23.5	19.4	16.6	13.3	10.9	5.67

## Constant Current Discharge (Amperes) at 25 °C (77°F)

F.V/Time	5min	10min	15min	20min	30min	45min	1h	2h	3h	4h	5h	6h	8h	10h	20h
1.85V/cell	339.7	276.4	256.7	227.1	186.2	146.0	119.7	68.2	50.1	40.0	34.3	29.4	23.6	19.7	10.6
1.80V/cell	442.3	338.9	297.0	256.8	210.0	163.5	129.4	72.5	52.1	41.2	34.3	30.2	24.4	20.5	10.8
1.75V/cell	488.1	366.4	320.5	273.6	216.3	168.1	134.8	74.9	52.9	42.0	35.1	30.9	24.7	20.7	10.9
1.70V/cell	522.6	390.3	337.5	285.4	222.0	172.5	138.6	77.2	54.2	43.1	36.0	31.5	25.1	20.9	11.1
1.67V/cell	568.2	417.5	356.1	301.0	230.9	176.4	142.6	79.4	56.3	44.3	36.9	32.1	25.5	21.2	11.2
1.60V/cell	612.4	442.9	374.5	317.1	239.2	183.4	146.5	81.7	57.7	45.6	37.9	32.7	25.7	21.4	11.3

### Discharge Characteristics

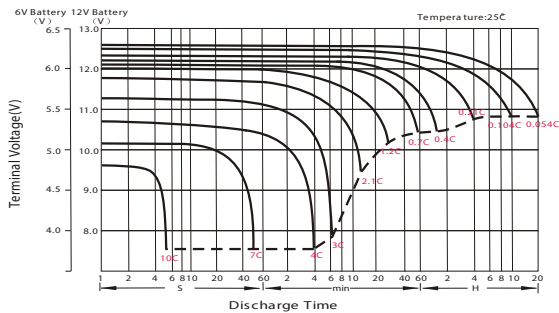

### Float Charging Characteristics

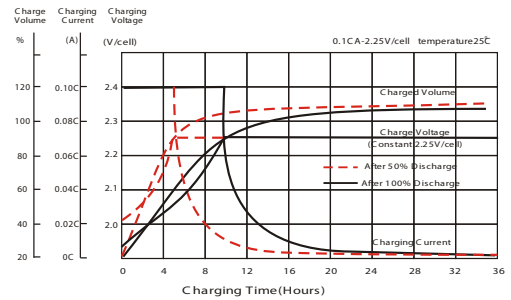

### Temperature Effects in Relation to Battery Capacity

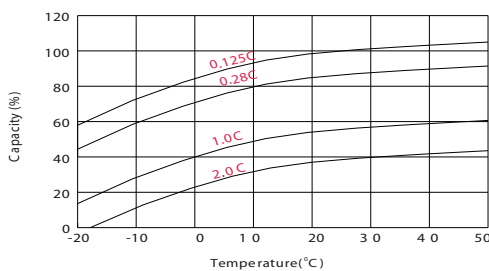

### Effect of Temperature on Long Term Float Life

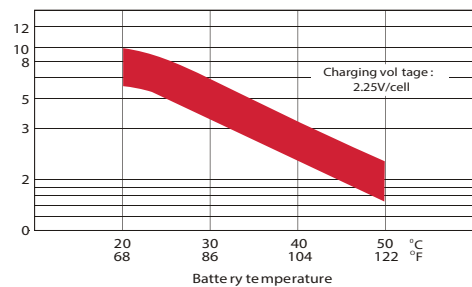

### Self Discharge Characteristics

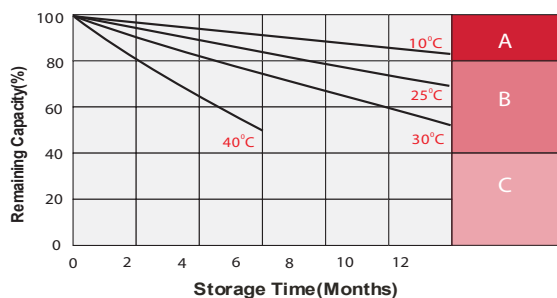

**A**

No supplementary required  
(Carryout supplementary charge before use if 100% capacity is required.)

**B**

Supplementary charge required before use. Optional charging way as below:  
 1. Charged for above 3 days at limited current 0.25CA and constant voltage 2.25V/cell.  
 2. Charged for above 20 hours at limited current 0.25CA and constant voltage 2.25V/cell.  
 3. Charged for 8 ~ 10 hours at limited current 0.05 CA.

**C**

Supplementary charge may often fail to recover the capacity.  
The battery should never be left standing till this is reached.