



Physical Specification

Part Number:	CBG80-2
Length:	170 ± 2 mm (6.69 inches)
Width:	72 ± 2 mm (2.83 inches)
Container Height:	205 ± 2 mm (8.07 inches)
Total Height (with terminal):	212 ± 2 mm (8.35 inches)
Approx Weight:	Approx 5.8 kg (12.8lbs)

Specifications

	Nominal Voltage	2V	
	Nominal Capacity (20HR)	65AH	
Terminal Type	Standard Terminal	T6	
	Optional Terminal	-	
Container Material	Standard Option	ABS	
	Flame Retardant Option (FR)	ABS (UL94:VO)	
Rated Capacity	80.0 AH/4.00A	(20hr,1.80V/cell, 25°C / 77°F)	
	75.0 AH/7.50A	(10hr,1.80V/cell, 25°C / 77°F)	
	64.5 A H/12.9A	(5hr,1.75V/cell, 25°C / 77°F)	
	56.1 AH/18.7A	(3hr,1.75V/cell, 25°C / 77°F)	
	44.0 AH/44.0A	(1hr,1.60V/cell, 25°C / 77°F)	
Max Discharge Current	450A (5s)		
Internal Resistance	Approx 1.6mΩ		
Discharge Characteristics	Operating Temp. Range	Discharge: -20 ~ 55°C (-4 ~ 131°F)	
		Charge: 0 ~ 40°C (32 ~ 104°F)	
		Storage: -20 ~ 50°C (-4 ~ 122°F)	
	Nominal Operating Temp. Range	25 ± 3°C (77 ± 5°F)	
	Cycle Use	Initial Charging Current less than 18.75A. Voltage 2.4V ~ 2.5V at 25°C (77°F) Temp. Coefficient -5mV/°C	
	Standby Use	No limit on Initial Charging Current Voltage 2.25V ~ 2.3V at 25°C (77°F) Temp. Coefficient -3mV/°C	
	Capacity affected by Temperature	40°C (104°F)	103%
25°C (77°F)		100%	
0°C (32°F)		86%	
Design Floating Life at 20°C	15 Years		
Self Discharge	Canbat batteries may be stored for up to 6 months at 25°C(77F) and then a refresh charge is required. For higher temperatures the time interval will be shorter.		

Dimensions

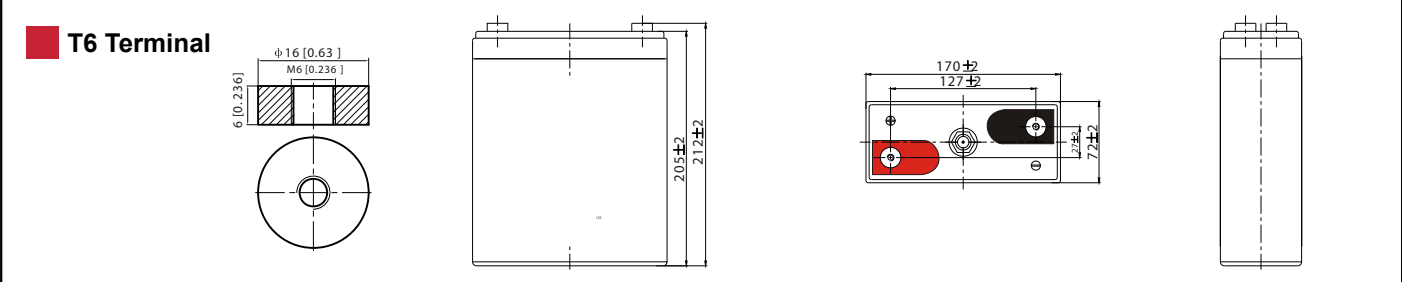

ALL DATA IS SUBJECT TO CHANGE WITHOUT NOTICE

Constant Current Discharge (Amperes) at 25 °C (77°F)

F.V/Time	20min	30min	45min	1h	2h	3h	4h	5h	6h	7h	8h	9h	10h	20h
1.85V/cell	65.3	51.3	39.1	34.0	21.7	16.5	13.7	11.8	10.2	9.03	8.15	7.44	7.04	3.84
1.80V/cell	74.9	57.3	43.2	37.5	23.5	17.7	14.5	12.4	10.7	9.45	8.54	7.83	7.36	4.00
1.75V/cell	84.2	63.0	46.6	40.1	24.9	18.7	15.2	12.9	11.1	9.79	8.81	8.07	7.50	4.08
1.70V/cell	90.7	67.5	49.5	42.5	26.4	19.5	15.7	13.3	11.5	10.1	9.08	8.28	7.68	4.14
1.67V/cell	94.3	70.2	51.3	44.0	27.0	20.1	16.1	13.6	11.7	10.3	9.21	8.39	7.77	4.17
1.60V/cell	102.2	75.0	55.1	46.7	28.1	20.9	16.7	14.0	12.0	10.5	9.38	8.57	7.92	4.23

Constant Power Discharge (Watts) at 25 °C (77°F)

F.V/Time	20min	30min	45min	1h	2h	3h	4h	5h	6h	7h	8h	9h	10h	20h
1.85V/cell	123.9	98.1	75.2	65.6	42.0	32.1	26.7	23.2	20.1	17.8	16.1	14.7	13.9	7.61
1.80V/cell	140.4	108.5	82.3	72.1	45.3	34.3	28.2	24.2	21.0	18.6	16.8	15.4	14.5	7.91
1.75V/cell	155.9	118.0	88.0	76.6	47.8	36.1	29.5	25.1	21.6	19.2	17.3	15.9	14.8	8.06
1.70V/cell	166.2	125.6	93.2	80.9	50.5	37.5	30.3	25.8	22.4	19.8	17.8	16.3	15.1	8.16
1.67V/cell	170.8	128.8	95.7	83.2	51.5	38.6	31.0	26.2	22.7	20.0	18.0	16.5	15.3	8.23
1.60V/cell	183.1	136.7	102.2	87.8	53.3	39.9	32.1	27.0	23.1	20.4	18.3	16.8	15.6	8.34

Discharge Characteristics

